

PCB LAYOUT

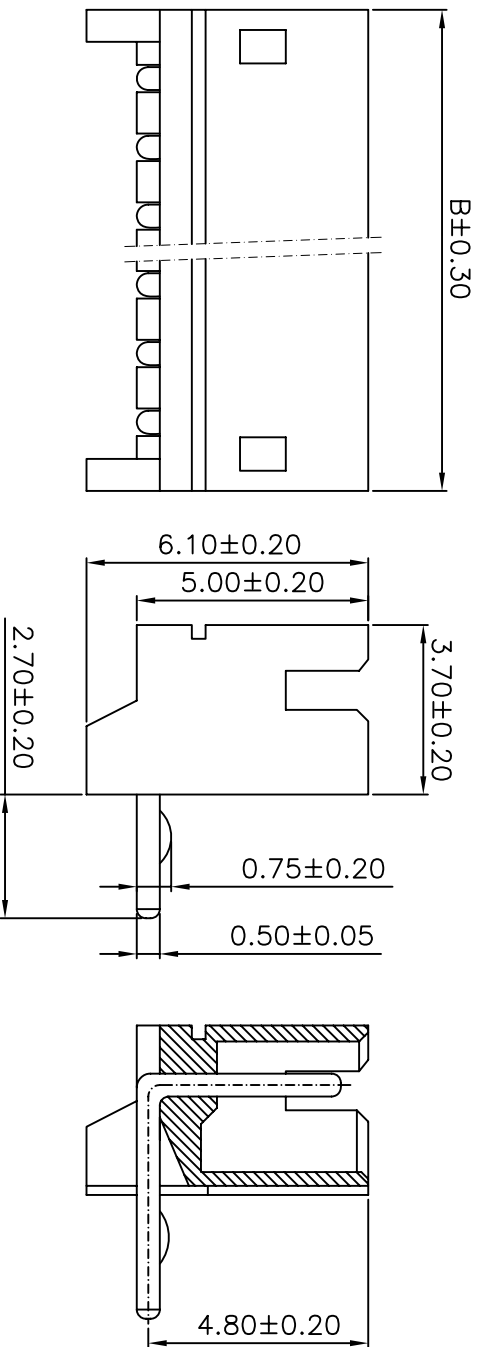

PART NO	DIMENSION	
	A	B
SCT1501WR-02	1.50	4.50
SCT1501WR-03	3.00	6.00
SCT1501WR-04	4.50	7.50
SCT1501WR-05	6.00	9.00
SCT1501WR-06	7.50	10.50
SCT1501WR-07	9.00	12.00
SCT1501WR-08	10.50	13.50
SCT1501WR-09	12.00	15.00
SCT1501WR-10	13.50	16.50
SCT1501WR-11	15.00	18.00
SCT1501WR-12	16.50	19.50
SCT1501WR-13	18.00	21.00
SCT1501WR-14	19.50	22.50
SCT1501WR-15	21.00	24.00
SCT1501WR-16	22.50	25.50

**SPECIFICATIONS**  
 Voltage rating: 100V AC, DC  
 Current rating: 1A, AC, DC (AWG#26)  
 Withstanding Voltage: 500V AC/minute  
 Insulation resistance: 500MΩ/min  
 Temperature range: -25°C - +85°C  
 Contact resistance: 20mΩ max

**WAFER**

Part No: SCT1501WR-XXP  
 Poles: 02-16  
 Material: Nylon 66, UL94V-0  
 Q'TY: 1000 pcs/bag

OPERATION	~ 10	±0.15	DRAW	Judy.Huang	2006/05/02	SCALE	mm	 森康达电子有限公司 SCONDAR ELECTRONIC LIMITED	
DESIGN	20 ~ 30	±0.30	CHECK	Micky.Liu	2006/05/02	UNIT	A4		
ANGLE	30 ~	±0.50	APPROVE	Hellen.Li	2006/05/02	SHEET	1/1	PART NO.	SCT1501WR-XXP
DATE	05/12/27	NEW	CHANGE			PROJ.		TITLE:	ZH1.5 90C WAFER
REV	0	MODIFICATION DESCRIPTION	APPROVE			DRAWING NO.			SCT1501

1 2 3 4 5 6 7 8 9 10